

ANDERSON BANKS

SOLICITORS • NOTARIES • ESTATE AGENTS

ASSIGNATION OF CROFT TENANCY

5 AND 6 HACKLETT, ISLE OF BENBECULA HS7 5QD



- Croft land extending to 12.6 Ha or thereby
- Blackhouse ruins
- Central and scenic location

OFFERS IN THE REGION OF £29,000

WWW.ANDERSONBANKS.CO.UK

The opportunity has arisen to purchase the assignation of the tenancy of 5 and 6 Hacklett, Benbecula. Services to the croft are located nearby. The area of the crofts extends to some 12.6Ha or thereby mainly comprising of rough grazings together with the ruins of the original black house and sheilings.

Crofting is a system of landholding unique to the Highlands and Islands of Scotland which is normally held on a tenancy. This may or may not include a house and farm buildings.

When looking to tenant a croft, a person must obtain the approval of the Crofting Commission www.crofting.scotland.gov.uk The Crofting Commission's aim is to promote the well-being of crofting communities. They will consider several points when an application is received which include the specific needs and long term interests of the community, and the skills a new tenant will bring, suitability of the new tenant in terms of their experience and plans for the croft. The suitability of the proposed tenant is of prime importance and they will be asked to give plans for the working and stocking of the croft as well as previous experience and skills which would be useful to the township. The Commission are able to refuse an assignation if they feel the proposed tenant is not suitable.

ENTRY By mutual arrangement.

POST CODE HS7 5QD

VIEWING Strictly by prior arrangement through the selling agents.

PRICE Offers in the region of **£29,000** are expected.

TRAVEL Please see www.calmac.co.uk for ferry information to and from the Western Isles and www.flybe.com for flight information.

WHAT TO DO NEXT INTERESTED PARTIES SHOULD REGISTER THEIR INTEREST WITH THE SELLING AGENTS AS SOON AS POSSIBLE. THE SELLING AGENTS MAY SET A CLOSING DATE FOR OFFERS BUT ARE NOT OBLIGED TO DO SO. THE SELLERS ARE NOT OBLIGED TO ACCEPT THE HIGHEST OR INDEED ANY OFFER.

OFFERS SHOULD BE SUBMITTED TO THE SELLING AGENTS IN SCOTTISH LEGAL TERMS AND A SCOTTISH SOLICITOR SHOULD BE INSTRUCTED BY THOSE INTENDING TO OFFER.

Note: The particulars have been carefully prepared, after due enquiry, but are provided as a guide only. Measurements are approximate. The particulars do not form part of any contract. While the agents consider that the information and opinions are fair and accurate, interested parties must not rely on any statement whether oral or written made by the agents.



22 Argyll Square, Oban, PA34 4AT
Tel: 01631 563158 Fax: 01631 565459
Email: info@andersonbanks.co.uk

Uachdar, Isle of Benbecula, Western Isles, HS7 5LY
Tel: 01870 602061 Fax: 01870 602878
Email: uist@andersonbanks.co.uk

WWW.ANDERSONBANKS.CO.UK

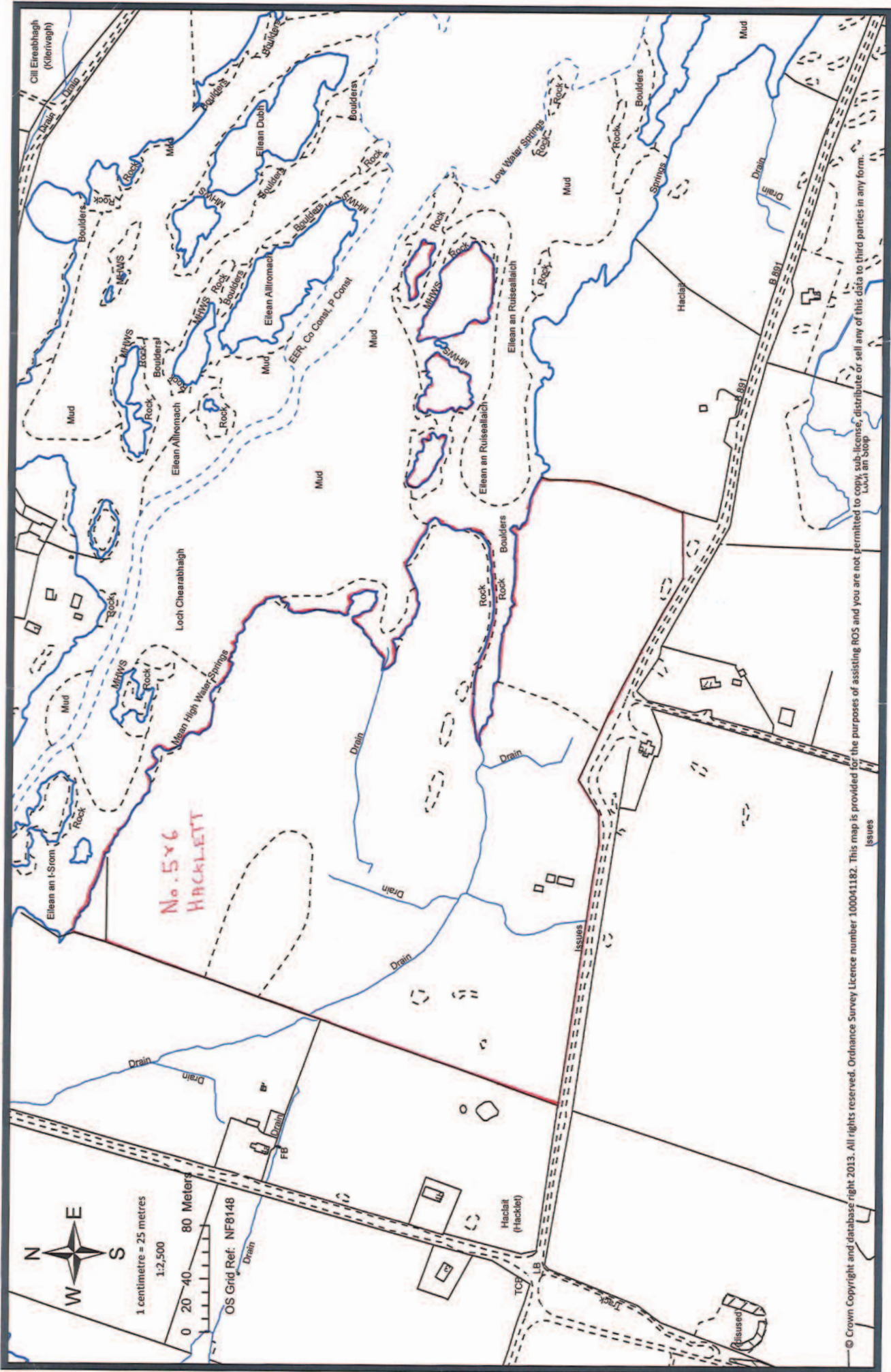

No. 5x6
HACKLETT



1 centimetre = 25 metres
1:2,500

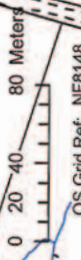

OS Grid Ref: NF8148

© Crown Copyright and database right 2013. All rights reserved. Ordnance Survey Licence number 100041182. This map is provided for the purposes of assisting ROS and you are not permitted to copy, sub-license, distribute or sell any of this data in any form. Lúthán Stóp Issues